

**SEVEN MOUNTAINS  
EMS COUNCIL**



**ACTIVE THREAT....**

**BLEEDING CONTROL**

**2016-17 Regional Project**

# INDEX

Background. . . . .	1
Deployment Kits. . . . .	2
Individual Kit Contents. . . . .	3
Individual Items:	
Top Zipper. . . . .	4
Rear Zipper . . . . .	4
Left Side. . . . .	4
Right Side. . . . .	5
Front Zipper. . . . .	5
Inside Rear. . . . .	6
Inside Main . . . . .	6
Inside Front . . . . .	7
Front. . . . .	7
Within tub (outside kit). . . . .	8
Training Aides	
Chitogauze XR Pro. . . . .	10
Dyna-Stopper. . . . .	11
Emergency Bandage . . . . .	12
HALO Vent . . . . .	15
Patient Mover . . . . .	16
SAM XT Tourniquet . . . . .	17
Conclusion. . . . .	19

Respond To:  
X 523 Dell Street  
Bellefonte, PA 16823

713 Bridge St., Suite 18  
Selinsgrove, PA 17870



Phone: (814) 355-1474 or  
(570) 473-7834

Fax: (814) 355-5149

Web: [www.smemsc.org](http://www.smemsc.org)

## Background

**Council recognized Regional EMS Agencies need for increased availability to mass casualty supplies in planning for and responding to a mass casualty event – natural or man-made; accidental or intentional.**

**Outcomes based research from the last several mass trauma events (most being mass shooting situations) have shown that the greatest survival rates are experienced when “**STOP THE BLEED**” is priority #2 (right behind scene safety).**

**Using funds available through Seven Mountains EMS Council’s 2016-17 grant with the PA Department of Health, Bureau of EMS; Council initiated a program whereby bleeding control supplies could be made available throughout the Region to supplement local supplies during organized events that could potentially overwhelm the local EMS system.**

**Following is an overview of the program and kits that are available throughout the Region. Comments and suggestions are welcome.**

-- PLEASE NOTE --

**FOR THIS PROGRAM TO BE BENEFICIAL...COUNCIL CONSIDERS STAFF EDUCATION & FAMILIARIZATION WITH THE SPECIFIC EQUIPMENT AND SUPPLIES FOUND WITHIN THE KIT AS A MANDATORY REQUIREMENT FOR PARTICIPATION IN THIS PROGRAM.**

**EQUIPMENT FAMILIARIZATION (THROUGH IN-SERVICE TRAINING) IS REQUIRED FOR ALL PERSONNEL BEING DEPLOYED WITH THESE KITS. DON’T ALLOW THE FIRST TIME YOU TRY TO USE AN “EMERGENCY BANDAGE” BE IN THE MIDDLE OF CHAOS.**

CENTRAL PENNSYLVANIA’S EMS COUNCIL



Active Threat/Bleeding Control Supplies

**Bleeding control kits will be deployed in quantities of 6 within a plastic container. Along the back of the container are 6 Patient Movers – available if needed. Also within that container, you will find a small Tupperware container with this manual & training supplies/videos.**



Kit Contents - less training supplies

## Personal Kit Contents

### Top Zipper

- 5" Trauma Shears
- 1 Dyna Stopper (Trauma Dressing)

### Front Zipper

- 4 pair, XL Exam Gloves
- 1 Roll, 2" Hypo-Silk Tape
- 10 Patient Tracking 'Scan' Bracelets

### Rear Zipper

- 2 Pks. – Halo Vent (1 vented, 1 non-vented each)

### Left Side

- 6 4" Roller Gauze

### Right Side

- 6 Cyalume glow sticks (Blue)
- 6 Cyalume glow pucks (Red)



### Inside Rear

- 1 Black Sharpie marker
- 2 Chitogauze XR Pro Kit

### Inside Front

- 3 Emergency Bandage (Israeli Bandage)



### Inside Main

- 4 SAM XT Tourniquet
- 5 Dyna-Stopper (Trauma Dressings)

### Front (under buckle)

- 3 28FR Nasopharyngeal Airways
- 3 pks – Surgical lubricant

Kits are sealed to help assure completeness. Please advise if kit(s) were opened so restocking can be accomplished. Opening of one kit, for familiarization is permitted.

Individual Items:

Top Zipper:



Bandage Shears



Dyna-Stopper

Rear Zipper:



HALO Vent



Opened to show contents

Left Side:



Roller Gauze

Right Side:



Glow Stick - Blue



Glow Puck - Red (2 each)

Front Zipper:



Exam Gloves - Tape



Stat Bands

Inside Rear:



Curaplex Chitogauze Kit



Chitogauze XR-Pro



Sharpie

Inside Main



SAM XT Tourniquet



Dyna-Stopper



Inside Front:



The Emergency Bandage



Emergency Bandage - unwrapped



Emergency Bandage - Top View



Emergency Bandage - Pt. Contact Side

Front:



Nasopharyngeal Airway & Lubricant

Within tub (outside kit):

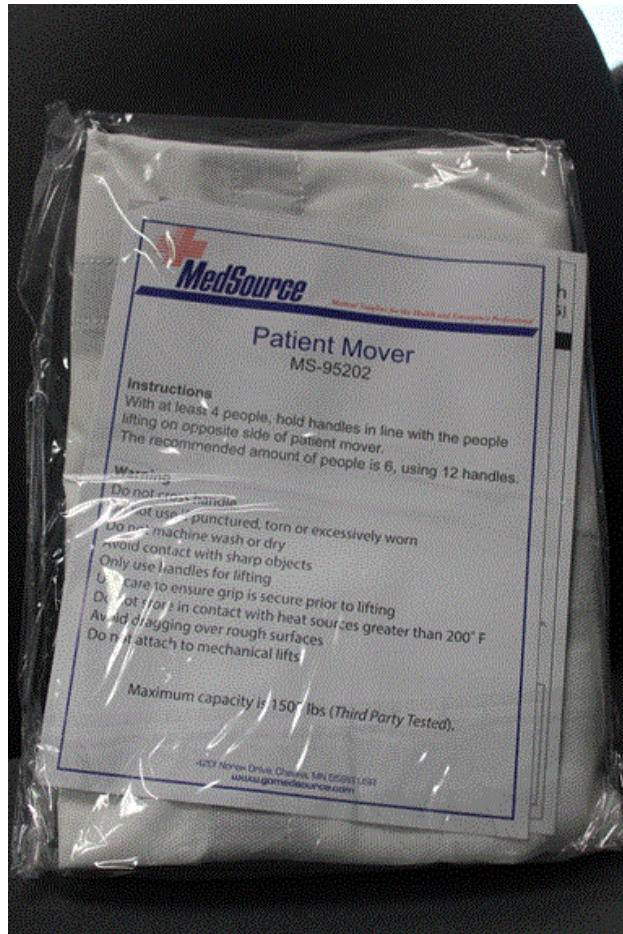

Patient Mover

# Training Aides

Videos are available on the Program CD. These are not intended to represent current Commonwealth Protocol and/or appropriate patient care. They are just a representation of appropriate field use of the products according to their manufacturer.

**Always follow local protocol when treating a patient.**

## Chitogauze XR Pro

- Training product available within tub\*.
- Video's on CD
  - HemoCon ChitoGauze
  - Wound Packing
  - Prometheus ChitoGauze XR Pro\*
  - Tourniquet or Wound Packing



\*Training kits have “TRAINING” Dressings. Different manufacturer but same concept for usage.

## Dyna-Stopper

- Training product available within tub.

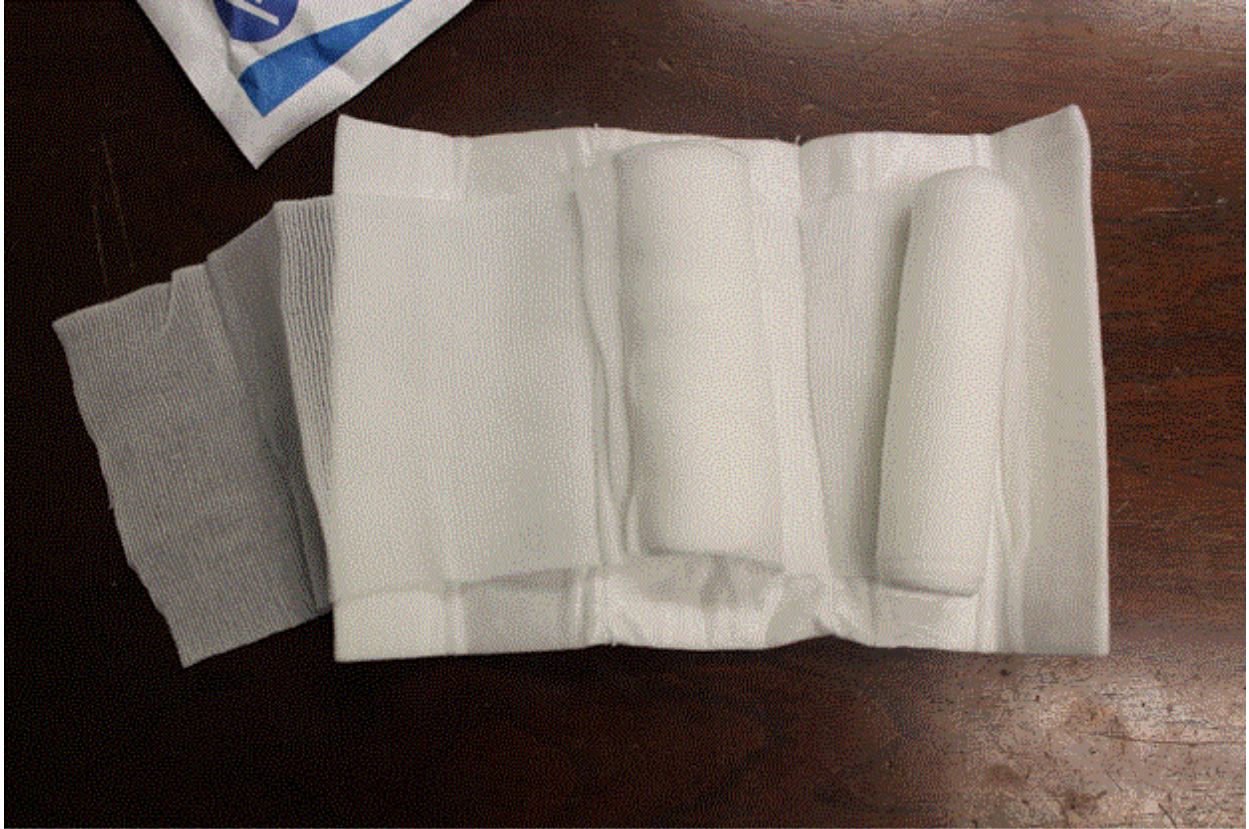

## Emergency Bandage

- Training product available within tub.
- Video's on CD
  - The Emergency Bandage\*

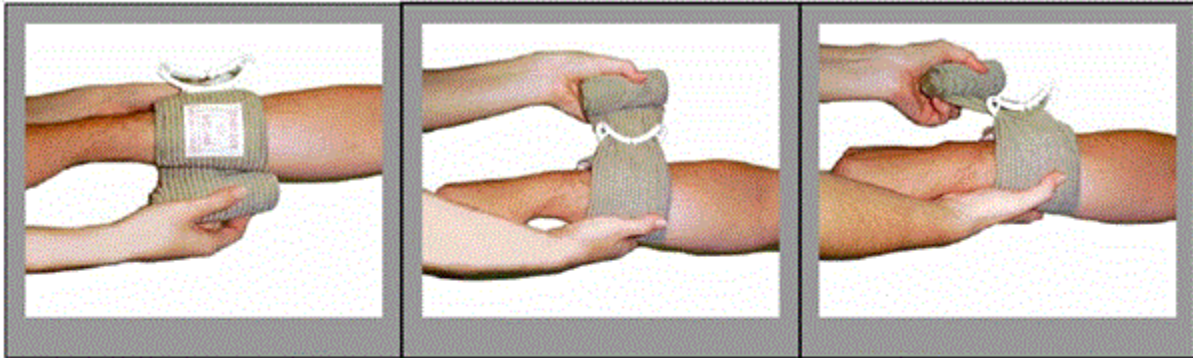

**1** Place pad on wound & wrap the elastic bandage around limb or body part

**2** Insert elastic bandage into pressure bar

**3** Tighten elastic bandage



**4** Pull back – forcing pressure bar down onto pad

**5** Wrap elastic bandage tightly over pressure bar and wrap over all edges of pad

**6** Secure hooking ends of closure bar into elastic bandage



**4 inch bandage sterile packaging**



**Closure Bar**

**Pressure Bar**



**4 inch bandage (civilian version)**





# HALO Vent

- Video's on CD
  - HALO Chest Seal
  - HALO Seals
  - HALO Vent Instructional Video\*



## Patient Mover

- Minimum 4 people required for safe use.

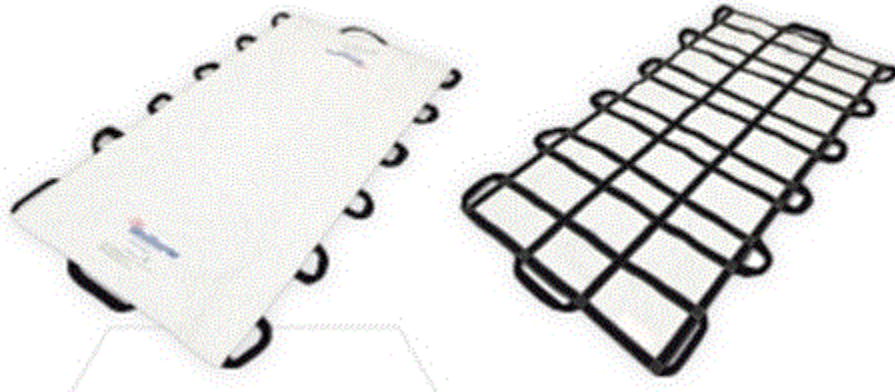

# SAM XT Tourniquet

- Training product available within tub.
- Video's on CD
  - SAM XT Extremity Tourniquet
  - SAM XT Training – High & Tight Application
  - SAM XT Training – Partner Aid, Upper Extremity
  - SAM XT Extremity Tourniquet\_Sam XT in Action
  - CTS Video

## SAM XT

**TECH SPECS**

**PACKAGED SIZE & WEIGHT\***  
 Length: 2.5 in (6.3 cm)  
 Width: 1.5 in (3.8 cm)  
 Height: 7.25 in (18.4 cm)  
 Weight: 3.8 oz (108 g)

**OPERATING SPECIFICATIONS**  
 TRUFORCE™ Buckle Technology auto-locks to engage strap holes within circumferential range:  
 5.5 in - 25 in (13.9 cm - 88.9 cm)

**MODELS AVAILABLE\*\***  
 Military Black (SAM XT-BM)  
 Civilian Orange (SAM XT-BC)

**MIL-STD-810G PROVEN**

\*Size and weight vary by configuration and manufacturing process.  
 \*\*Patent Pending.  
 SAM® is a registered trademark in the United States and other countries.

⚠

The **SAM® XT** Extremity Tourniquet should only be used as directed by military service component guidelines, EMS authority, or under the supervision of a medical practitioner.

**REMOVAL INSTRUCTIONS**

1



Leave tourniquet in place until directed by a medical practitioner.

**TO REMOVE SAM® XT**  
 Release the ⌚ Time Band & untwist metal windless rod.

2



Lift the tab on the front of the buckle to allow prongs to retract.

**DISPOSAL**  
 Dispose of device per facility policy.



MILITARY  
BLACK



CIVILIAN  
ORANGE

**curaplex®**

Distributed by Samson Inc. LLC, a family of companies:  
 Blood Flow Restriction, LLC, O&A Medical Inc.,  
 Curaplex, LLC, Curaplex Medical, Inc.,  
 & Tension Health Services, Inc.  
 5000 Maple Crossing Blvd., Ogden, UT 84203, 801.363.2729  
[www.curaplex.com](http://www.curaplex.com)

**SAM**  
MEDICAL

[sammedical.com](http://sammedical.com)

# SAM<sup>®</sup> XT

Extremity Tourniquet

## INSTRUCTIONS FOR USE

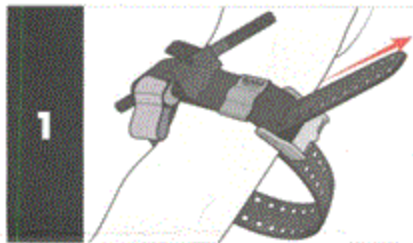

Locate the site of injury\* and place the **SAM<sup>®</sup> XT** around the limb, directly onto the skin 2-3 inches above the wound.

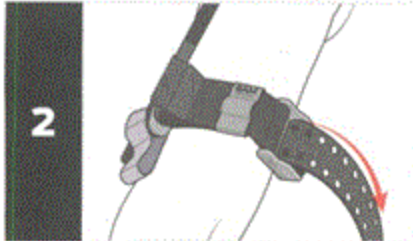

Insert the tip of the strap through the opening in the buckle. Grip the strap close to the buckle and pull hard and steady against the buckle until it stops. Maintaining tension, press the strap back upon itself to hold it in place.

**DO NOT COVER WINDLASS C-HOOKS.**

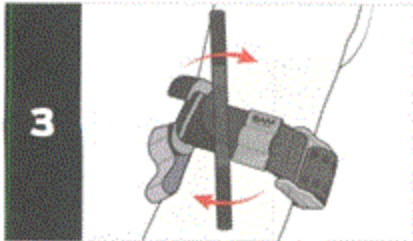

Twist the metal windlass rod until the bleeding has stopped.

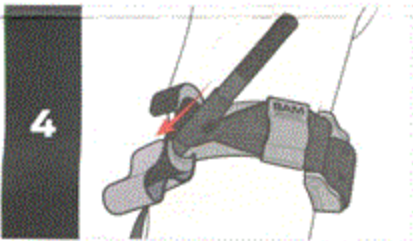

Fix the metal windlass rod inside the Windlass C-hooks and confirm that bleeding has stopped. If bleeding continues, try to further tighten the tourniquet with additional twists of the metal windlass rod. If this fails to stop the bleeding, apply a second **SAM<sup>®</sup> XT** side by side next to the first and ensure bleeding has stopped.

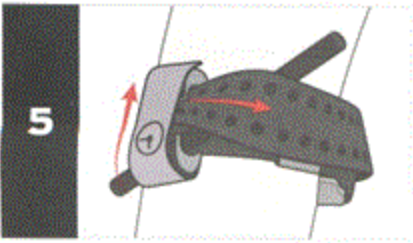

Wrap strap between Windlass C-hooks; over rod and around the limb.

Secure the (C) Time Band over Windlass C-hooks and record time of application.

### ⚠ CAUTION ⚠

The **SAM<sup>®</sup> XT** **MUST NOT** be applied over solid objects within the clothing.

\* If the site of the injury is not easily seen, place the **SAM<sup>®</sup> XT** as "high & tight" as possible on the injured arm or leg. When the situation permits, re-evaluate the injured limb and place the **SAM<sup>®</sup> XT** directly onto the skin 2-3 inches above the wound.

**SAM<sup>®</sup>**  
MEDICAL

sammedical.com

We at Seven Mountains hope that these kits are never used!! Hopefully you consider them a complement to the EMS supplies currently available throughout the Region and a benefit you your agency during event planning & staffing. They were designed to provide you with the equipment required to initiate your immediate, life-saving care – **STOPPING THE BLEED** – while compact and light enough to not overburden our providers or get in the way of other essential care. Again, your comments & suggestions are welcomed. Stay Safe and Thank You for all you do!!

